

MOSO® bamboo x-treme® accessories

MOSO® fasteners and screws

With these fasteners MOSO® Bamboo X-treme® Decking and Cladding can be easily installed. When installed correctly there will be 5-6 mm gaps between the boards. The fasteners are supplied with matching stainless steel screws (square bit). For installation on aluminium sub frame joist (not provided by MOSO®), special screws are available.

| Product Code | Item | Material | Colour | Dimensions fastener (mm) | Dimensions screw (mm) |
|------------------|------------------------------------|------------------------------|--------|--------------------------|-----------------------|
| CLIP-SCREW-BX08 | Fastener Asymmetric (20 mm) | Stainless steel A2 (AISI304) | Brown | 27x22.5x10.8 | 4.5x30 |
| CLIP-SCREW-BX031 | Fastener (20 mm) | Stainless steel A2 (AISI304) | Brown | 27x22.5x10.8 | 4.5x30 |
| CLIP-SCREW-BX301 | Fastener starter/end (20 mm) | Stainless steel A2 (AISI304) | Brown | 27x17x31 | 4.5x30 |
| CLIP-SCREW-BX09 | Fastener Asymmetric (18 mm) | Stainless steel A2 (AISI304) | Brown | 27x22,5x9,8 | 4.5x30 |
| CLIP-SCREW-BX041 | Fastener (18 mm) | Stainless steel A2 (AISI304) | Brown | 27x22.5x9.8 | 4.5x30 |
| SCREW-03-01 | Screw for aluminum sub frame joist | Stainless steel A2 (AISI410) | Brown | | 4.2x16 |

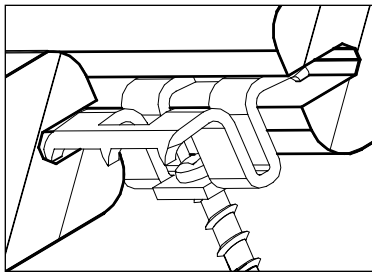

recommended number of fasteners/m²

decking*

137 mm
-20 pcs/m²

155 mm
-17 pcs/m²

178 mm
-14 pcs/m²

cladding**

137 mm
-14 pcs/m²

75 mm
-26 pcs/m²

*) Based on distance of 462.5 mm between the sub frame joist axes.

**) Based on distance of 600 mm between the sub frame joist axes.

CLIP-SCREW-BX08 / BX09

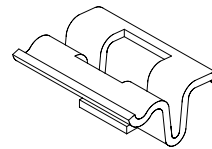

CLIP-SCREW-BX031 / BX041

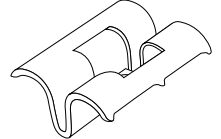

CLIP-SCREW-BX301

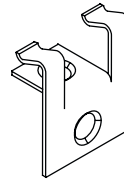

sub frame joists

The MOSO® Bamboo X-treme® sub frame joists are made of the same material as the decking boards: Thermo-Density® heat-treated bamboo.

| Product Code | Material | Finish | Dimensions (mm) |
|--------------|------------------------|------------|-----------------|
| BO-SB150 | Thermo-Density® bamboo | Unfinished | 2440x70x40 |
| BO-SB155 | Thermo-Density® bamboo | Unfinished | 2440x60x40 |

endprofile

The BO-DTHT162 is an endprofile for an elegant finish of the sides of the decking. It is placed vertically against the sides of the terrace to cover the sub frame.

| Product Code | Material | Finish | Dimensions (mm) |
|--------------|------------------------|------------|-----------------|
| BO-DTHT162 | Thermo-Density® bamboo | Unfinished | 1850x137x20 |

maintenance & cleaning

Under the influence of wind, rain, sun and snow the decking will weather. MOSO® recommends to impregnate and maintain the pre-oiled decking with Woca Maintenance materials. Unfinished decking must be treated with Sikkenes Saturator or Woca oil right after installation. The silicium carbid broom and machine disk are perfectly suited to clean and smooth the decking surface of Bamboo X-treme® and to remove splinters due to the capability to sand the surface in addition to cleaning it.

| Product Code | Material |
|--------------|--------------------------------------|
| OIL-WOCA-002 | 1 Ltr WOCA Maintenance Oil Natural |
| OIL-WOCA-003 | 2,5 Ltr WOCA Maintenance Oil Natural |
| RM-xx | Repair marker*** |

